

### LG PREMIUM FILTER CARTRIDGE REPLACEMENT INSTRUCTIONS

#### CAUTION

- Read, understand, and follow both the Safety Information on the back page of this document and the following use instructions BEFORE installation and use of the system.
- Change the filter cartridge every 6 months.

Replace your LG PREMIUM FILTER whenever the water filter indicator light is on, or whenever water flow from the refrigerator water dispenser or icemaker decreases noticeably. You may need to change filter cartridges more often as use and local water conditions dictate.

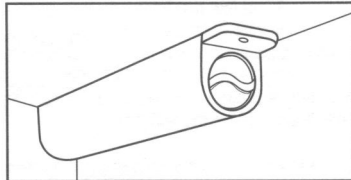

1. Remove the old cartridge.

Twist the handle of the cartridge counterclockwise.

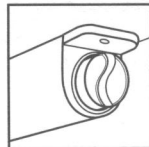
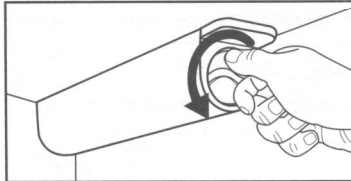

2. The cartridge will eject slightly with a clicking sound.

3. Pull out the cartridge.

**TIP:** Some water may remain in the old cartridge, so hold the cartridge with the handle down to avoid spillage.

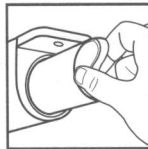

To purchase replacement water filter cartridges, visit your local appliance dealer or parts distributor. You can also visit our website: [www.lgappliances.com](http://www.lgappliances.com) or call 1-877-714-7486

4. Remove the protective blue cap from the new filter cartridge. Insert the new cartridge. With the handle in the vertical position, push the new filter cartridge into the housing until it stops.

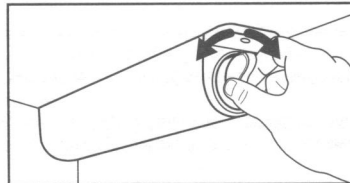

5. **TIP:** When inserting the new cartridge, twist the handle slightly left to right, while pushing inward.

6. Twist the handle of the filter cartridge clockwise about 1/4 turn until you feel it stop.

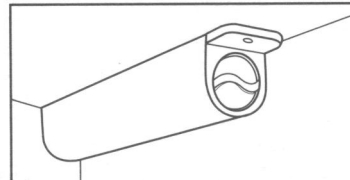
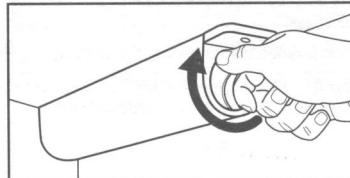

7. Flush the refrigerator water system after replacing the water filter cartridge. Run the refrigerator water dispenser for 5 minutes to purge the refrigerator water system. Discard the purged water.

8. After replacing the LG PREMIUM FILTER cartridge, reset the water filter status display and indicator light by pressing and holding the reset button for 3 seconds.