



OPERATION INSTRUCTIONS FOR THE FLUSH FIT REGISTER BOOSTER™ MODEL: HC500

READ AND SAVE THESE INSTRUCTIONS IMPORTANT NOTICE

With the use of any electrical appliance, it is important to observe all basic precautions to minimize the risk associated with use, such as electrical shock, fire, or injury to persons. Read these instructions before using your Flush Fit Register Booster™.

NEVER EXPOSE YOUR FLUSH FIT REGISTER BOOSTER™ TO TEMPERATURES OVER 140°F (60°C)

INSTALLATION

FLOOR REGISTER 4" X 10"

1. Plug the small molded end of the power cord into the top of the Flush Fit Register Booster™.
2. Plug the wall transformer end of the power cord into a 120 Volt AC outlet.
3. Follow directions for **OPERATION SETTINGS** before placing in register.
4. Remove floor register and replace with the Flush Fit Register Booster™.

WALL REGISTER 4" X 10"

1. Drill (two) holes with a 3/16" drill bit from the bottom side of the Flush Fit Register Booster™ grille. The holes should be drilled in the pre-molded location as pictured below.
2. Plug the small molded end of the power cord into the top of the Flush Fit Register Booster™.
3. Plug the wall transformer end of the power cord into a 120 Volt AC outlet.
4. Follow directions for **OPERATION SETTINGS** before placing in register.
5. Remove the wall register and replace with the Flush Fit Register Booster™.
6. Secure the Flush Fit Register Booster™ in place.

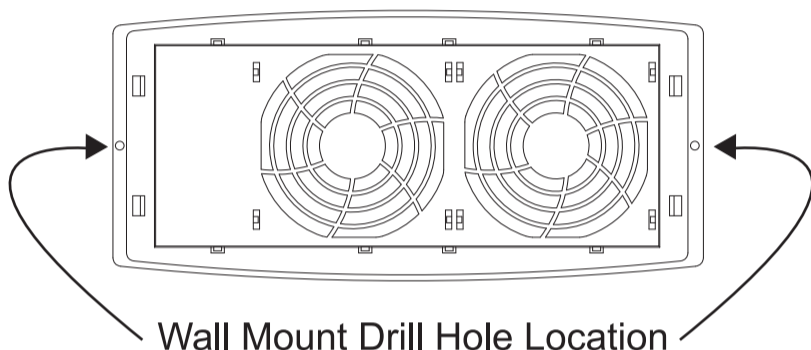

CLEANING AND MAINTENANCE

Before cleaning the Flush Fit Register Booster™ disconnect the power cord from the outlet. Dust may be removed from the exterior surfaces using a soft cloth, the round brush attachment of your vacuum cleaner, or a cloth that has been lightly moistened with water and a mild, non-abrasive detergent. Dust accumulation in the interior of the unit may be removed by using the small round brush attachment of your vacuum cleaner. Accumulation of dust in the interior will be minimized by regular replacement of your furnace filter as recommended by the manufacturer.

IMPORTANT WARNINGS

1. The Flush Fit Register Booster™ will be as warm as the air that is delivered from the register of your forced air furnace and/or cooling system. The maximum temperature for the register is 140° Fahrenheit or 60° Centigrade. Your Flush Fit Register Booster™ should never be exposed to higher temperatures or temperatures below freezing.
2. Do not in any way block the air grilles of the Flush Fit Register Booster™.
3. Unplug the Flush Fit Register Booster™ when not in use. Turn the unit off before unplugging.
4. Do not operate the Flush Fit Register Booster™ with a damaged plug or cord, if the unit malfunctions, becomes noisy when operating, has been dropped or otherwise damaged, or if the housing is damaged or broken. Return the unit for inspection, replacement, or repair.
5. The Flush Fit Register Booster™ should never be exposed to moisture. Do not use the unit in an open window, bathroom, or laundry area where it may come in contact with water.
6. The Flush Fit Register Booster™ is designed for indoor use only.
7. Place the Flush Fit Register Booster™ and the electrical cord where it will not be tripped over, and is out of the traffic pattern.
8. Never insert any object or allow any object to enter the Flush Fit Register Booster™ through the bottom or top grilles, as this may damage the unit or cause it to malfunction.
9. Do not use the Flush Fit Register Booster™ near flammables such as gasoline, paint, or natural gas.
10. The Flush Fit Register Booster™ is intended for use as described in the instructions only. Other use may cause fire, electrical shock, damage to the unit, or injury to persons and will void any warranty by the manufacturer.
11. If it is necessary to use an extension cord, use a minimum 18 gauge cord.
12. Pressure on the bottom or top grilles of the Flush Fit Register Booster™ may cause the fan impeller to contact these grilles and damage the unit.
13. Do not use strong detergents or flammable liquids to clean the Flush Fit Register Booster™.
14. The housing of your Flush Fit Register Booster™ is sealed at the factory. THERE ARE NO SERVICE-ABLE PARTS INSIDE. Attempting to open the housing will expose you to dangerous electricity, may cause fire and will void any and all warranty.

FLOOR & WALL REGISTER 4" X 12", 6" X 10" & 6" X 12"

Adaptor plate sold separately.

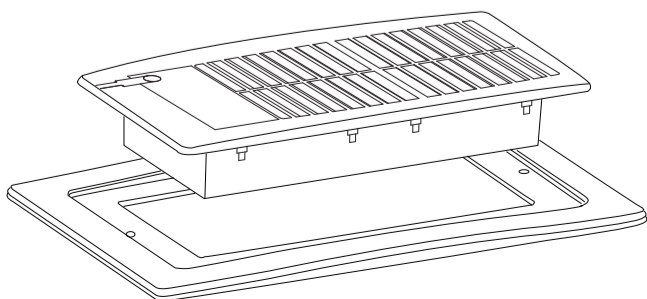

OPERATION SETTINGS

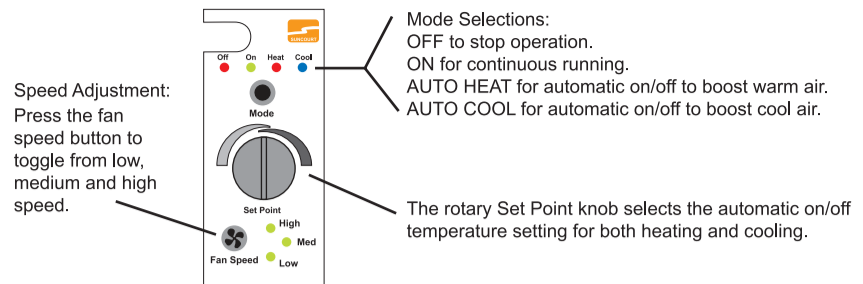

1. Set the Function switch to Auto Heat (winter) or Auto Cool (summer).
2. To adjust the fan motor ON/OFF point rotate the Set Point knob in the proper direction for your heating or cooling application until the fan motor switches ON, then slightly turn the control knob in the opposite direction until the fan motor stops. DO NOT FORCE.

FOR HEATING

Position the Function switch to Auto HEAT.

STEP ONE

Turn clockwise until fan motor runs.

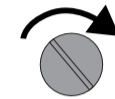

STEP TWO

Turn counterclockwise until fan motor stops.

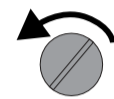

FOR COOLING

Position the Function switch to Auto COOL.

STEP ONE

Turn counterclockwise until fan motor runs.

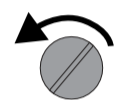

STEP TWO

Turn clockwise until fan motor stops.

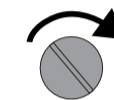

IMPORTANT NOTE

To shorten the length of time that your Flush Fit Register Booster™ continues to run after the forced air furnace or air conditioner has shut off, rotate the Set Point knob control slightly further, as in Step Two.

The Flush Fit Register Booster's™ memory will retain all settings automatically (speed, function, and temperature set point). The HC500 has 3 speeds.

ONE YEAR LIMITED WARRANTY

Subject to the following limitations, Suncourt Inc. warrants that the Flush Fit Register Booster™ will, for 1 (one) year from date of original retail purchase, but not exceeding two years from date of manufacture, remain free from appearance of defects in workmanship or materials. This warranty is subject to the following limitations: (a) manufacturer's liability is limited to the replacement or repair of the unit, as decided by the manufacturer; (b) a defective unit must be returned, prepaid, with proof of purchase; and (c) this warranty does not apply to defects resulting from the alteration, abuse, accidental damage, unauthorized repair, or misuse of the unit. This warranty is given in lieu of all other warranties, guarantees, and conditions on manufacturer's part, and the manufacturer shall have no tortious or other liability in respect to this Flush Fit Register Booster™.

Actual product appearance may differ from illustrations.

Suncourt reserves the right to modify any or all of its products' features, designs, components and specifications without notice.

www.suncourt.com
SUNCOURT INC. • P.O. BOX 40 • DURANT, IOWA 52747-0040
1-800-999-FANS (3267)

WNT500-1009-C01

PRINTED IN CHINA