



# **FILTERSCAN<sup>®</sup>**

Reference Guide  
Version 3.02

The information contained herein is proprietary and is not to be used for purposes other than as an aid in the operation and/or maintenance of the of the product described herein and is not to be released or reproduced by anyone without the written permission of CleanAlert, LLC.

Due to CleanAlert's constant strive for product improvement, minor discrepancies between the actual product, text and illustrations may exist. All information contained herein is based on the latest specifications at the time of publication and is subject to change without notice.

**FILTERSCAN<sup>®</sup>** is a registered trademark of CleanAlert, LLC.

# Contents

---

<b>Introduction</b>	<b>1</b>
In The Box	1
Tools Required	1
Safety	1
Application	1
FCC Compliance	2
IC Compliance	2
<b>Monitor Installation</b>	<b>2</b>
<b>Receiver Installation</b>	<b>6</b>
<b>Operation</b>	<b>7</b>
System Monitoring	7
Alarm Modes	7
Clogged Air Filter	8
Low battery	8
Malfunction	8
Calibrating When Installing a New Air Filter	8
Automatic Adjustment	9
<b>Frequently Asked Questions</b>	<b>9</b>
<b>Specifications</b>	<b>10</b>
<b>Warranty</b>	<b>10</b>
<b>Wireless Option</b>	<b>11</b>
Transmitter	11
Receiver	11
Learn Mode	11
Low Battery Indicator	12
Identification Address	12
Revision History	12
<b>Appendix</b>	<b>13</b>
Glossary	13
Indicators	13
Battery Replacement	13
Alarm Indications	14
Monitor Installation on Duct Board	14
HVAC Configurations	15
Optional Dry Contact Relay Output	17
Disclaimer	17

# Introduction

---

Congratulations on your purchase of the CleanAlert **FILTERSCAN**<sup>®</sup> Air Filter Clog Detection System. The CleanAlert **FILTERSCAN**<sup>®</sup> is intended for continuous and automatic monitoring of the clogging of an air filter installed into a household or commercial forced air heating, air conditioning, or heat pump system. Please read all instructions carefully to insure years of trouble-free operation. We're sure you will enjoy outstanding performance when the **FILTERSCAN**<sup>®</sup> is installed by a qualified HVAC technician and properly operated.

## In The Box

1. **FILTERSCAN**<sup>®</sup> Monitor
2. 4 "AA" Batteries (FS-242-B, FS-242-BW and FS-242-BWR models only)
3. Installation and Operation Guide
4. Template for attaching the **FILTERSCAN**<sup>®</sup> Monitor to an air duct
5. Mounting Screws
6. Packaging / box
7. External wall adapter power supply – Optional (FS-242-B, FS-242-BW and FS-242-BWR models only)
8. **FILTERSCAN**<sup>®</sup> Receiver (FS-242-CWR and FS-242-BWR models only)
9. 2 "AAA" Batteries (Receiver only)

## Tools Required

1. Power Drill
2. 7/64" Drill bit
3. 3/8" Drill bit or Step Drill
4. #2 Phillips Screwdriver
5. 1/2" Drill Bit (if Model CA-4DP Differential Pressure kit ordered)
6. Eye and Ear Protection
7. Dust Mask

## Safety

### **WARNING! READ AND UNDERSTAND ALL INSTRUCTIONS.**

Failure to follow all instructions may result in electrical shock or serious personal injury.

## Application

**FILTERSCAN**<sup>®</sup> is an air filter clogging detection system. It has been designed to monitor the amount of dirt building on an air filter and alert the user when the amount of clogging reaches a pre-determined threshold.

The **FILTERSCAN**<sup>®</sup> Monitor is compatible with most air filters ranging in differential pressure drop from 0.10"wg to 4.0"wg and with single and multi-speed blower HVAC systems, and most VAV (Variable Air Volume) systems. Note: The Monitor must be mounted downstream if the VAV system is set to the constant torque mode.

If the wireless option has been installed, the **FILTERSCAN**<sup>®</sup> Monitor will transmit alarm conditions to a remote Receiver. The Receiver may be located up to 100 feet from the Monitor depending upon line-of-sight and obstacles located between the Monitor and Receiver.

## FCC Compliance

*This device complies with Part 15 of the FCC Rules. Operation is subject to the following two conditions: (1) this device may not cause harmful interference, and (2) this device must accept any interference received, including interference that may cause undesired operation.*

*NOTE: This equipment has been tested and found to comply with the limits for a Class B digital device, pursuant to Part 15 of the FCC Rules. These limits are designed to provide reasonable protection against harmful interference in a residential installation. This equipment generates, uses and can radiate radio frequency energy and, if not installed and used in accordance with the instructions, may cause harmful interference to radio communications. However, there is no guarantee that interference will not occur in a particular installation. If this equipment does cause harmful interference to radio or television reception, which can be determined by turning the equipment off and on, the user is encouraged to try to correct the interference by one or more of the following measures:*

- Reorient or relocate the receiving antenna.
- Increase the separation between the equipment and the receiver.
- Connect the equipment into an outlet on a circuit different from that to which the receiver is connected.
- Consult the dealer or an experienced radio/TV technician for help.

*Changes or modifications not expressly approved by the party responsible for compliance could void the user's authority to operate the equipment.*

FCC ID Number: **AUPFS-242**

## IC Compliance

*This Class B digital apparatus complies with Canadian ICES-003.*

*Cet appareil numérique de la classe B est conforme à la norme NMB-003 du Canada.*

*This device complies with Industry Canada license-exempt RSS standard(s). Operation is subject to the following two conditions: (1) this device may not cause interference, and (2) this device must accept any interference, including interference that may cause undesired operation of the device.*

*Cet appareil est conforme à Industrie Canada exempts de licence RSS norme. Opération est soumise aux deux conditions suivantes: (1) cet appareil ne peut pas causer de brouillage et (2) cet appareil doit accepter toute interférence, y compris les interférences pouvant causer un fonctionnement intempestif du dispositif.*

Model: FS-242-BW      Modèle: FS-242-BW

Model: FS-242-CW      Modèle: FS-242-CW

IC Certification/Registration Number IC: **10341A-FS242**

Numéro de Certification / d'enregistrement les IC: **10341A-FS242**

## Monitor Installation

---

The CleanAlert **FILTERSCAN**<sup>®</sup> Air Filter Clog Detector, Model FS-242, **MUST** be installed at the RETURN side plenum (NOT the SUPPLY side: See Appendix) either upstream, downstream, or differentially across the air filter (using the optional tubing kit Model CA-4DP). Best results have been found when installing downstream of the air filter (that is, between the air filter and the system blower fan, usually located at the return duct of the HVAC system). Note: The Monitor must be mounted downstream if the VAV system is set to the constant torque mode.

**WARNING!**

**Ensure that the HVAC system blower motor/fan is turned OFF until told to otherwise!**

1. The **FILTERSCAN**<sup>®</sup> Monitor is to be attached to the external wall of the air duct, either upstream or downstream from the air filter to be monitored. NOTE: The minimum distance for positioning the **FILTERSCAN**<sup>®</sup> Monitor from the air filter is six (6) inches. Also Note: The Monitor must be mounted downstream if the VAV system is set to the constant torque mode.
2. Locate an area on the return duct, preferably downstream from the air filter (that is, between the air filter and the system blower), large enough to place the Monitor template on a flat surface and where there are NO obstacles inside the duct. There should be sufficient clearance (6" minimum) from the surrounding walls and from any components of the air supply system.
3. Place the Monitor template at the location found in the previous step, such that "TOP" is facing upward. NOTE: The **FILTERSCAN**<sup>®</sup> Monitor front panel must be clearly visible when installed.
4. Using the template, drill one large hole (3/8") for the sensor and four small holes (7/64") for the mounting screws.  
NOTE: If installing on a DUCT BOARD plenum, see below. Otherwise Go To 5.
  - a. Obtain Toggle Bolts (available at Home Depot)
    - (1) [#1/8" x 2" SKU 261181 Package of 25](#) for \$5.21
    - (2) [#1/8" x 3" SKU 261203 Package of 25](#) for \$7.25
  - b. Use toggle bolts that are one inch longer than the thickness of the duct board to allow the toggle to expand after inserting through mounting hole.
  - c. Drill 3/8" holes at the four **FILTERSCAN** Monitor mounting hole locations (see Drill Template) as well as the Sensor Tube location.
  - d. Insert the bolt alone through the **FILTERSCAN** housing from the inside. Once through the housing, screw on the toggle a few threads such that the fins fold toward the housing. Do this for all four mounting holes.
  - e. Apply silicone sealant or air duct sealer to the inner sides of the toggle (see Appendix) such that when the toggle expands inside the duct, the silicone will seal the hole and secure the toggle to the inside of the duct to help prevent the toggle from dropping into the duct if the screw is removed at a later date after the sealant has cured.
  - f. Insert each toggle through the duct board holes, insuring the Sensor Tube aligns with the Sensor Tube hole.
  - g. Once all four toggles are fully inserted through the duct board, lightly pull the housing away from the duct board while tightening each bolt, until all four are securely fastened, without crushing the duct board. Make sure the Sensor Tube seal has been squeezed between the housing and duct board to insure no air leakage.
5. Attach the **FILTERSCAN**<sup>®</sup> Monitor by aligning its sensor tube with the larger hole and secure the Housing using the mounting screws supplied. The sensor tube does not extend into the duct.

**WARNING!**

**Do NOT insert anything into the Sensor Tube! Doing so could result in sensor damage and malfunction.**



6. **IMPORTANT!** Set the Upstream/Downstream switch so that it matches the **FILTERSCAN**<sup>®</sup> Monitor position with respect to the air filter (that is, OFF for upstream mounting or ON for downstream or differential mounting). The switch can be accessed by removing the front cover of the Monitor.

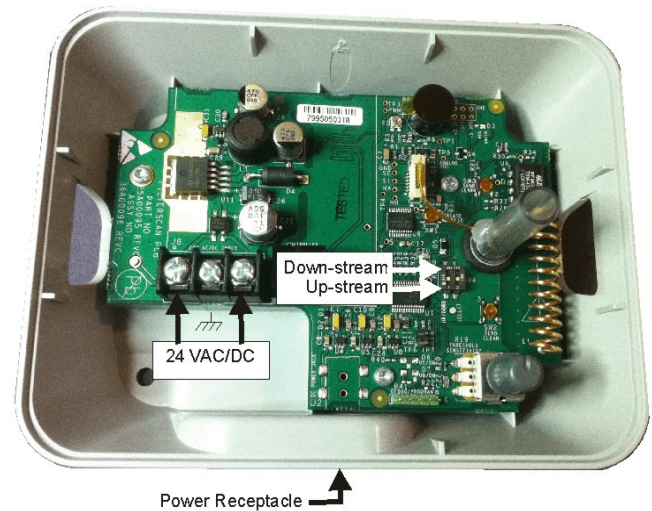

7. Apply power:
  - a. Models FS-242-B, FS-242-BW, and FS-242-BWR - Insert the wall mount power adapter into the **FILTERSCAN**<sup>®</sup> power receptacle, or install 4 AA batteries and replace the Monitor front cover. See Appendix for battery replacement.
  - b. Models FS-242-C, FS-242-CW, and FS-242-CWR – These models should be installed by a qualified electrician and are powered from the HVAC system's auxiliary 24 VAC/DC power supply. A typical installation will have that power run through installer-provided conduit to the **FILTERSCAN**<sup>®</sup>.
  - c. The **STATUS** LED should come on green momentarily then turn and remain red. This indicates that the unit has not yet been calibrated to the air filter and HVAC system upon which it is installed.

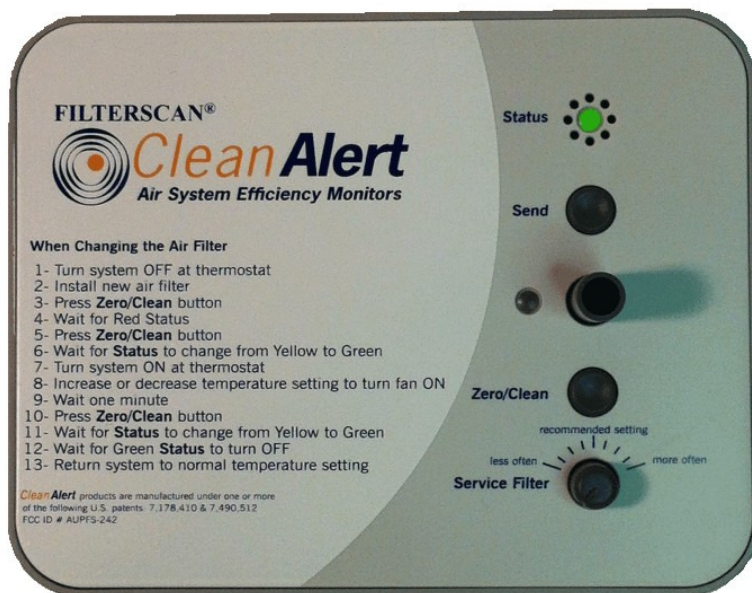

8. Wait for approximately 15 seconds (warm up and stabilization time).
9. Install a clean, new air filter into the HVAC system.
10. Depress the **ZERO/CLEAN** button ONCE. The **STATUS** LED will blink yellow for several seconds while the **FILTERSCAN®** records the system's FAN OFF condition, then turn to blinking green. This indicates proper operation and that you are ready to move to next step. If the unit detects the zero air flow is out of limits, the **STATUS** LED will blink red. In this case, check to see that the HVAC system blower fan is OFF and no conditions exist during this part of the calibration that would cause air to be moving within the HVAC ducts, such as opening and closing of doors or windows. If no such condition exists, contact the company that you purchased the **FILTERSCAN®** from for repair information.
11. Adjust the thermostat temperature adjustment to either increase or decrease the room temperature by at least ten degrees, enough to signal the HVAC system to turn on heating or cooling at maximum blower speed.
12. Once the HVAC system blower fan turns on, wait one minute for the blower fan to stabilize.
13. Depress the **ZERO/CLEAN** button once. The **STATUS** LED should turn from blinking green to blinking yellow for several minutes. This indicates that the unit is calibrating itself to the air filter and HVAC system into which it is installed. Once calibration is completed, the **STATUS** LED will blink green a few times then turn off.
14. Return the thermostat to normal operating temperature. This concludes the installation of the **FILTERSCAN®** Monitor.
15. The **SERVICE FILTER** control is a fine tuning adjustment that has been calibrated to the mid-range, Recommended Setting at the factory. This control allows the user to change the point at which the clog alarm will be triggered. Turning the **SERVICE FILTER** adjustment clockwise will cause the **FILTERSCAN®** to issue an alarm at a lower level of filter clogging. Turning the **SERVICE FILTER** adjustment counter-clockwise will cause the **FILTERSCAN®** to issue an alarm at a higher level of filter clogging.

## Receiver Installation – Wireless Option Only

---

1. Remove the front cover of the Receiver by depressing the latch at the top of the Receiver housing, rotating the front cover downward, and lifting the front cover out of the housing.



2. Install two AAA batteries.

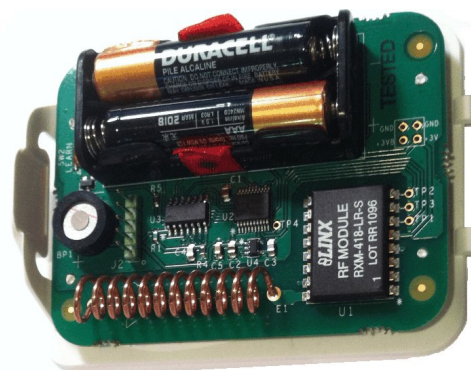

3. Your **FILTERSCAN**<sup>®</sup> Monitor and Receiver have been paired (matched) at the time of manufacturing and should require no further attention.
4. To test the pairing of the Monitor and Receiver:
  - a. Monitor and Receiver should be turned on and in close proximity to each other.
  - b. Test the Receiver by inserting a paperclip through the small hole in the front cover of the Receiver until the click of a switch is felt, then **immediately** pressing the **SEND** button on the Monitor. This transmits a signal to the Receiver, which turns on the Red LED and Beeper.





5. To insure proper operation when Receiver is placed in a desired remote location, retest the Receiver as described above. This remote procedure may require two people.  
**NOTE:** Although the wireless transmission range is up to 100 feet, it is greatest with no obstructions between the Monitor (transmitter) and Receiver. Any obstructions, such as walls, floors, and ceilings will reduce the range of transmission, and relocation of the Receiver may be required. Retest with each location to ensure proper operation
6. Mount the Receiver vertically by using the screws or adhesive strip supplied.
7. Install the front cover by placing the bottom flanges into the housing and rotating the cover upward until the top latches into the housing.

## Operation

---

### System Monitoring

The **STATUS** LED will blink green approximately once per minute (called a heartbeat) to indicate that the unit is functioning properly. Usually the **FILTERSCAN**<sup>®</sup> will be in the standby mode, conserving power. It wakes up periodically to monitor air filter condition, battery level, and system operation. If no alarm conditions are detected, the **FILTERSCAN**<sup>®</sup> goes back to sleep after several minutes of monitoring.

**NOTE:** Should there be a power failure the **FILTERSCAN**<sup>®</sup> will save all parameters such as the clean air filter calibration and the current state of the air filter. When power is restored, the **FILTERSCAN**<sup>®</sup> Monitor will continue operation with no user action required. The same applies when replacing depleted batteries.

### Alarm Modes

The **FILTERSCAN**<sup>®</sup> provides both audible and or visual alarms indicating a clogged air filter, a low battery, or a system malfunction. There is also a wireless option which allows remote monitoring of system conditions.

**NOTE:** The HVAC system blower fan must be running when the **FILTERSCAN**<sup>®</sup> Monitor attempts to check air filter condition. Since the **FILTERSCAN**<sup>®</sup> Monitor checks the air filter condition periodically, it may take several days to detect, trigger, and alarm a clogged filter condition.

## Clogged Air Filter

When the **FILTERSCAN**<sup>®</sup> detects a clogged air filter, an alarm condition is triggered. The red **STATUS** LED will illuminate, blinking five times approximately every ten minutes until the alarm condition is reset. There will also be an audio alert which corresponds to the visual alarm indication. The clogged filter alarm is reset by following the instructions in the section "Calibrating When Installing a New Air Filter" below.

**NOTE:** A new air filter should always be installed whenever the CALIBRATE operation is performed.

## Low Battery

When the **FILTERSCAN**<sup>®</sup> detects a low battery condition, an Alarm condition is triggered. The **STATUS** LED will blink yellow approximately once per minute to indicate a low battery in the Monitor. Replacing the Monitor batteries (see the Appendix for instructions) will reset the alarm condition.

## Malfunction

When the **FILTERSCAN**<sup>®</sup> detects an internal malfunction, an alarm condition is triggered. The red **STATUS** LED will illuminate continuously until the malfunction is corrected. In the unlikely event this should occur, remove power from the **FILTERSCAN**<sup>®</sup> by removing the batteries, unplugging the optional AC Adapter, or in the case of conduit-powered models ("C") contacting your HVAC system electrician to have the power to the Monitor cut. Wait for a minute and restore power. If your **FILTERSCAN**<sup>®</sup> unit is operating with both AC Adapter and batteries installed, both will need to be removed in order to reset the malfunction. If this does not reset the malfunction alarm, contact the company that you purchased the **FILTERSCAN**<sup>®</sup> from for repair information.

## Calibrating When Installing a New Air Filter

Whenever a new air filter is installed, the **FILTERSCAN**<sup>®</sup> clog detector system must be calibrated. Calibration establishes the clogged air filter detection threshold based upon the condition recorded for a new air filter. When a new air filter is installed, its condition is recorded and saved in nonvolatile memory.

1. Insure that the HVAC system is **OFF** at the thermostat.
2. Remove the dirty air filter from the HVAC system.
3. Install a new, clean air filter into the HVAC system.
4. Make sure the **FILTERSCAN**<sup>®</sup> Monitor power is ON and the low battery indication is not being displayed.
5. Depress the **ZERO/CLEAN** button on the **FILTERSCAN**<sup>®</sup> Monitor.
6. Wait for the red **STATUS** LED to illuminate.
7. Depress the **ZERO/CLEAN** button again.
8. Wait several seconds for the **STATUS** LED to change from blinking yellow to blinking green.
9. Turn the HVAC system ON at the system thermostat.
10. Set the thermostat temperature adjustment to either increase or decrease the room temperature by four degrees, which should be enough to signal the HVAC system to turn heating or cooling on.
11. Wait one minute for the HVAC system blower fan to turn on and stabilize.
12. Depress the **ZERO/CLEAN** button again.
13. Wait several minutes for the **STATUS** LED to turn from blinking yellow to blinking green. During this time, the unit is recording the condition of a clean air filter.
14. Wait several seconds for the blinking green **STATUS** LED to turn OFF.
15. Return the thermostat to normal operating temperature.

Your **FILTERSCAN**<sup>®</sup> Monitor is now calibrated to the type of air filter you have installed. Depending on the air filter type and manufacturing tolerances, you may need to calibrate the **FILTERSCAN**<sup>®</sup> air filter clogging detector each time a new air filter is installed.

**Automatic Adjustment**    **ATTENTION - HVAC systems with two-speed blowers!** Typical HVAC systems will have different blower speeds for Heat and A/C. The **FILTERSCAN**<sup>®</sup> Monitor automatically adapts to the changes in HVAC blower speeds.

## Frequently Asked Questions

---

### All Models

Can the **FILTERSCAN**<sup>®</sup> be mounted upstream (on the supply side) of the HVAC blower?

*No, only upstream or downstream of the air filter or differentially across the air filter.*

Can I install the **FILTERSCAN**<sup>®</sup> on a multi-speed blower HVAC system?  
Yes.

Can I install the **FILTERSCAN**<sup>®</sup> on a Variable Air Volume (VAV) HVAC system?

*As of the writing of this manual, the **FILTERSCAN**<sup>®</sup> will operate with most VAV systems in production. Note: The Monitor must be mounted downstream if the VAV system is set to the constant torque mode.*

What effect, if any, does opening or closing air vent registers have on the **FILTERSCAN**<sup>®</sup> performance after the **FILTERSCAN**<sup>®</sup> has been calibrated to a new air filter?

*Any significant changes in system pressure caused by register changes or other factors will change the point at which the clog alarm will occur. The greater the number of system registers, the less effect on the system's pressure when one or two registers are changed and therefore the less effect on when the clog alarm will occur. Regular changes to system registers will make the performance unpredictable.*

### Model FS-242-C, CW, & CWR

How is the conduit mechanically connected to the **FILTERSCAN**<sup>®</sup> monitor?

*There is a conduit connector knock-out located on the lower side of the monitor housing.*

What voltage is acceptable to power the **FILTERSCAN**<sup>®</sup> monitor via the conduit?

*Typically 24V AC/DC, although an input voltage as low as 12V DC is acceptable.*

### Model FS-242-B, BW, & BWR

Do I have to install batteries if I power the Monitor from the optional AC adapter?

*No*

Can I utilize both the AC Adapter and batteries for backup?

*Yes, you can install batteries even though you also have an AC adapter installed. Such "backup" is unnecessary however because the monitor's non-volatile memory stores all operating parameters in the event of a power failure.*

### Receiver Model FS-201

How far can I mount the Receiver from the Monitor?

*Up to 100 feet, depending on line-of-sight. However, obstacles such as walls between the Receiver and Monitor will decrease the effective range of the device.*

Can multiple Receivers be utilized in a single monitor system?

*Yes. All receivers would be paired with the single monitor.*

Can a single Receiver be used with multiple monitors?  
*No, since each Receiver is paired with an individual monitor.  
Future Receiver models will have the capability to be paired with additional monitors.*

## Specifications

---

Pressure Differential Range	0.1 to 4.0 in H <sub>2</sub> O
Clog Filter Trigger Point	1.5 to 2 times initial differential pressure (at the recommended setting on the <b>SERVICE FILTER</b> control)
Temperature Range	32° to +122° F (0° to +50° C) Operating -40° to +257° F (-40° to + 125° C) Storage
Humidity	80% RH, non-condensing
Power Requirements (-B & -BW)	5.5 VDC at 25 mA Status LED on, 3 mA Transmitting, 60 uA Standby
Batteries, Monitor (-B & -BW)	(4) AA 2400 mAH
Batteries, Receiver	(2) AAA 1100 mAH
Battery Life	Approximately 1 year
Power Requirements (-C & -CW)	24 VAC/DC at 25 mA Status LED on, 3 mA Transmitting, 60 uA Standby
Insertion Depth into Duct	Does not extend into duct
Clogged Air Filter Alarm	Red <b>STATUS</b> LED & 2 KHz Beeper alternating ON & OFF five times
Low Battery Alarm	Yellow <b>STATUS</b> LED blinking approximately once per minute
Malfunction Alarm	Red <b>STATUS</b> LED continuously illuminated
Mounting	5 holes, 4 @ 7/64" and 1 @ 3/8"
Monitor Dimensions	6" x 4.625" x 1.5"
Receiver Dimensions	2.75" x 3.75" x 1.0"
Wireless Frequency	418 MHz
Transmission Range	Up to 100 feet, depending upon line-of-sight and obstacles
FCC Identification #	AUPFS-242
Industry Canada #	10341A-FS242

## Warranty

---

Limited warranty      Please refer to <http://www.cleanalert.com/termsOfSale.html> for full warranty text.

For the a period of one (1) year following the date of purchase of the Product, if the Product ceases to function and/or functions improperly due to a defect in material or workmanship, CleanAlert, LLC will repair or replace the Product (at its sole discretion) free of charge to the customer. This warranty does not apply to:

1. Damage caused by accident, abuse or mishandling of the Product after it has left CleanAlert, LLC's facility;
2. Acts of God;
3. Units which have been subject to unauthorized repair and/or have been opened, taken apart or otherwise modified;
4. Units not used properly;
5. Damages exceeding the cost of the Product; and
6. Damages that are considered normal wear and tear (in CleanAlert, LLC's sole discretion).

A Product requiring warranty service shall be sent by the customer to CleanAlert's facility in West Chester, PA. This warranty does **NOT** cover the costs of having the Product transported to CleanAlert, LLC for warranty service. The customer is responsible for safely sending the Product to CleanAlert, LLC.

## Wireless Option

---

### Transmitter

In a wireless system, the **FILTERSCAN**® Monitor contains a wireless transmitter, operating at a frequency of 418 MHz, which is activated whenever there is an alarm condition. Transmissions are very short in duration and intermittent until the alarm condition is reset.

Each **FILTERSCAN**® Monitor is randomly assigned one of over 16 million identification addresses at the time of manufacture. This is important in systems where neighbors have installed similar wireless systems.

### Receiver

The **FILTERSCAN**® Receiver contains a wireless receiver, also operating at a frequency of 418 MHz, which is activated intermittently, listening for an alarm condition. The Receiver listens for the **FILTERSCAN**® transmitter's identification address and responds only to transmissions originating from your system's Monitor. This prevents inadvertent activation when neighboring buildings also have **FILTERSCAN**® systems in operation.

### Learn Mode

Each **FILTERSCAN**® Receiver has the ability to learn and store a **FILTERSCAN**® Monitor's identification address. Your **FILTERSCAN**® system, consisting of a Monitor and a Receiver, has had both components identification addresses matched at the factory. In the event that a replacement Receiver is introduced into your system, that Receiver must learn the system Monitor's identification address. In order to accomplish this, both the Receiver and Monitor must be located close to each other. The steps are:

1. Remove the Receiver front cover.
2. Depress the **LEARN** button located next to the batteries.
3. Within 5 seconds, depress the **SEND** button at the Monitor. After several seconds, the Monitor will beep once. Then, after another several seconds, the monitor will beep twice.
4. Reinstall the Receiver front cover.
5. To confirm proper pairing of the Receiver to the Monitor,
  - a. After mounting the Monitor and Receiver, depress the **LISTEN** pushbutton by inserting a straightened paper clip through the small hole located near the bottom of the Receiver cover until the click of a switch is felt. See figure in section "Receiver Installation 4."
  - b. Within 5 seconds, depress the **SEND** pushbutton on the Monitor. This may require a second person.
  - c. The Red indicator should illuminate and the Beeper should sound for approximately five seconds, indicating that the Receiver is mounted within range of the Monitor.

**NOTE:** The best transmission range is obtained when a direct line-of-sight between the Monitor and Receiver exists. Any obstructions, such as floors and walls, will decrease the operating range of the system, and relocation of the Receiver may be required.

## Low Battery Indicator

Receiver: When the **FILTERSCAN**® Receiver detects a low battery condition, the Receiver's yellow **STATUS** LED will blink approximately once per minute.

Monitor: When the **FILTERSCAN**® Receiver detects a low battery condition at the Monitor, the Receiver's yellow **STATUS** LED will blink three times every minute.

## Identification Address

Creating an identification address is performed by depressing the **SEND** button on the Monitor. Immediately remove the Monitor cover. Wait about ten seconds until the first beep. Depress the **Create Address** button located inside the Monitor directly under the small flexible PCB (the center of the three push button switches). The green LED will start flashing. After about one second, depress the Create Address button again. The green LED will turn off. All of these steps must be completed before the second set of two beeps.

**NOTE:** The **Create Address** button is accessible internally in the Monitor and intended only to be used by factory technicians. Instructions are included here to allow the user to change the address in the unlikely event that a neighbor's FILTERSCAN happens to have the same address, and to eliminate interference from that neighbor's FILTERSCAN Monitor.

## Revision History

Rev. #	Effective	Summary:
DRAFT		Initial draft for review and validation.
Version 1.1	2/2/12	Initial release for review.
Version 2.0	5/25/12	Initial printing release.
Version 2.9	7/10/12	Initial website download release.
Version 2.91	7/20/12	Added Receiver alarm reset instructions.
Version 2.92	8/18/12	Added 6. & 7. to Tools Required
Version 2.93	8/17/12	Corrected various grammar errors
Version 2.94	10/30/12	Revised areas pertaining to VAV operation.
Version 2.95	2/27/13	Added "Note: The Monitor must be mounted downstream if the VAV system is set to the constant torque mode." where needed.
Version 2.96	3/14/13	Add reference to installation on duct board on page 3 at section 4.a.
Version 2.97	5/17/13	Add Warning statement at Monitor Installation 5. Page 3.
Version 2.98	5/21/13	Changed installation at 11. from four to ten degrees and add maximum blower speed
Version 2.99	6/7/13	Added duct board installation step 4.e. pertaining to sealant.
Version 3.00	6/24/13	Added HVAC configurations to Appendix and "NOT Supply Side" to Installation.
Version 3.01	6/25/13	Added optional relay output drawing and spec to Appendix
Version 3.02	8/7/13	Added (6" minimum) to Monitor Installation #2

# Appendix

---

## Glossary

Dirty Air Filter .....	An air filter which has been in use and has collected some amount of dirt or dust particles that discolor the filter fibers or element but do not substantially affect the air flow through it.
Clogged Air Filter .....	An air filter which has collected a sufficient amount of dirt or dust particles to not only discolor the filter fibers or element but decrease the air flow through the filter as well. The <b>FILTERSCAN</b> <sup>®</sup> typically identifies a filter as clogged when the differential pressure within an HVAC system increases to 1.5 to 2 times the initial differential pressure identified when the unit was calibrated with a clean filter.
Monitor .....	The sensor voltage detection and signal processing portion of the system, which may contain an optional wireless transmitter.
Receiver .....	The optional portion of the system containing a wireless receiver of data and indicating various alarm conditions.
Address .....	One of 16 million randomly assigned identification numbers of each monitor.

## Indicators

Green <b>STATUS</b> LED.....	The blinking Green <b>STATUS</b> LED at the <b>FILTERSCAN</b> <sup>®</sup> Monitor or Receiver indicates normal operation.
Yellow <b>STATUS</b> LED.....	The blinking Yellow <b>STATUS</b> LED at the <b>FILTERSCAN</b> <sup>®</sup> Monitor indicates a process is occurring and can also indicate a low battery condition at the Monitor or Receiver.
Red <b>STATUS</b> LED.....	The Red <b>STATUS</b> LED at the <b>FILTERSCAN</b> <sup>®</sup> Monitor and Receiver is an alarm indicator which blinks whenever an alarm condition occurs.
Beeper .....	The audible beeper at the <b>FILTERSCAN</b> <sup>®</sup> Monitor and Receiver is an alarm indicator which beeps whenever certain alarm conditions occur.

## Battery Replacement

Access .....	Remove the front cover from the <b>FILTERSCAN</b> <sup>®</sup> Monitor or Receiver housing. Remove the batteries.
Installation .....	Insert four (4) AA batteries in the battery holder of the <b>FILTERSCAN</b> <sup>®</sup> Monitor, or insert two (2) AAA batteries in the battery holder of the <b>FILTERSCAN</b> <sup>®</sup> Receiver, and replace the front cover. CleanAlert recommends using <b>DURACELL</b> <sup>®</sup> <b>COPPERTOP</b> batteries.

## Alarm Indications

### Monitor/Transmitter Alarm Indications

Alarm Condition	Alarm Indication	Clear Alarm Procedure
Normal Operation	<b>STATUS</b> LED flashes green every minute.	None
Clogged Filter	<b>STATUS</b> LED flashes red five times every ten minutes. Beeper sounds with LED flash.	Replace Filter and Recalibrate
Low Battery	<b>STATUS</b> LED flashes yellow every minute.	Replace Batteries
Sensor Failure	<b>STATUS</b> LED continuously on red.	Contact the company that you purchased the <b>FILTERSCAN</b> ® from for repair information

### Receiver Alarm Indications

Alarm Condition	Alarm Indication	Clear Alarm Procedure
Normal Operation	<b>STATUS</b> LED flashes green every minute.	None
Clogged Filter	<b>STATUS</b> LED flashes red five times every ten minutes. Beeper sounds with LED flash. Supersedes the Heartbeat indication.	Replace filter, recalibrate, and depress the Listen button of the Receiver for several seconds until a short beep is heard and the green LED illuminates
Receiver Low Battery	<b>STATUS</b> LED flashes yellow every minute.	Replace Receiver Batteries
Transmitter Low Battery	<b>STATUS</b> LED flashes yellow three times every minute. Supersedes the Heartbeat indication.	Replace Transmitter Batteries
Sensor Failure	<b>STATUS</b> LED continuously on red.	Contact the company that you purchased the <b>FILTERSCAN</b> ® from for repair information

## Monitor Installation on Duct Board

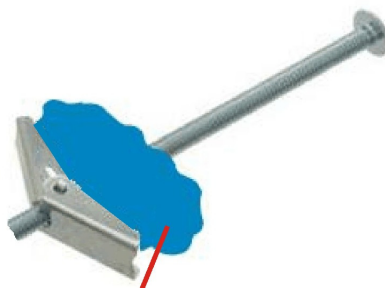

Add duct sealant to toggle before inserting. This will help prevent the toggle from falling into duct at a later date if the FILTERSCAN unit is removed from the duct.



Various HVAC Configurations for Monitor Installation

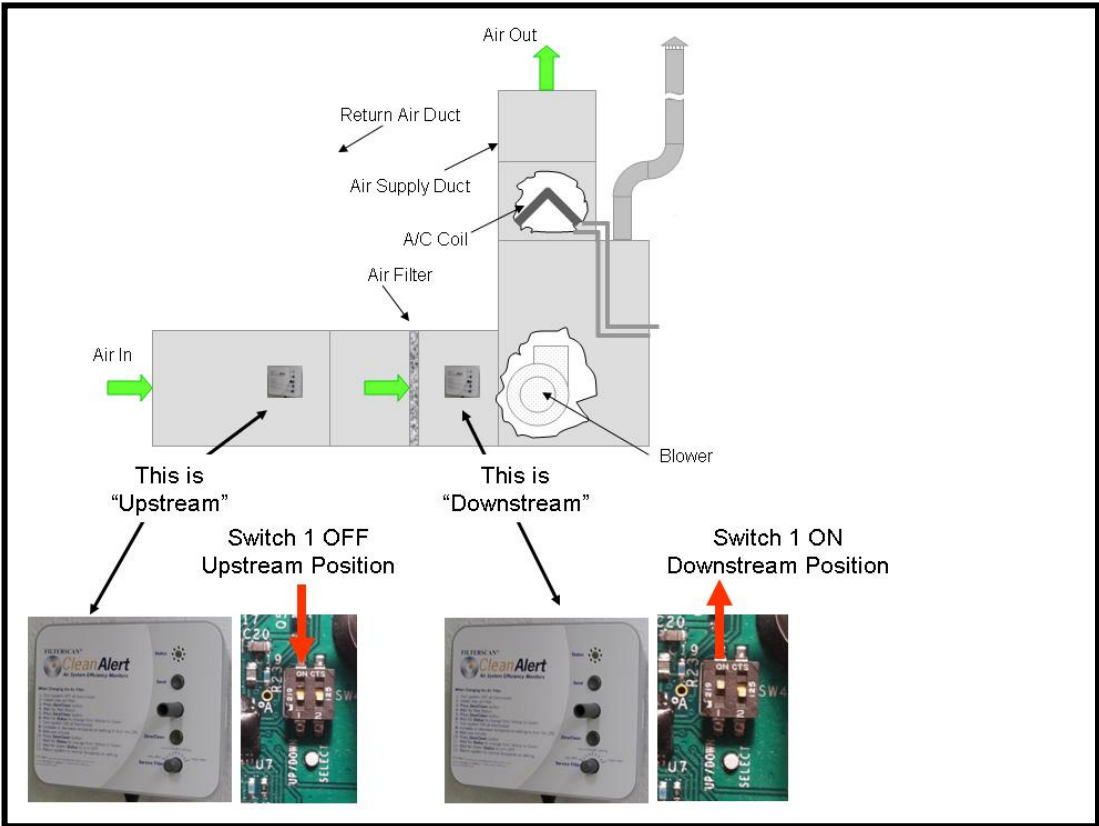
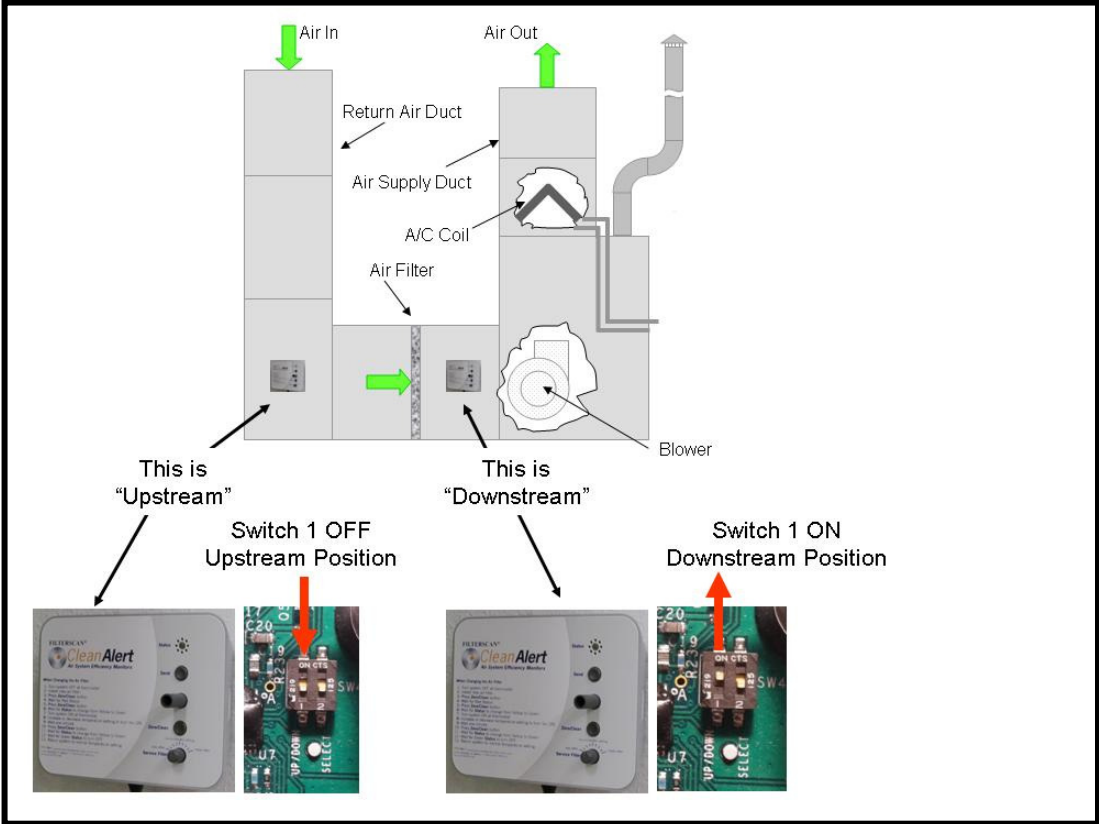

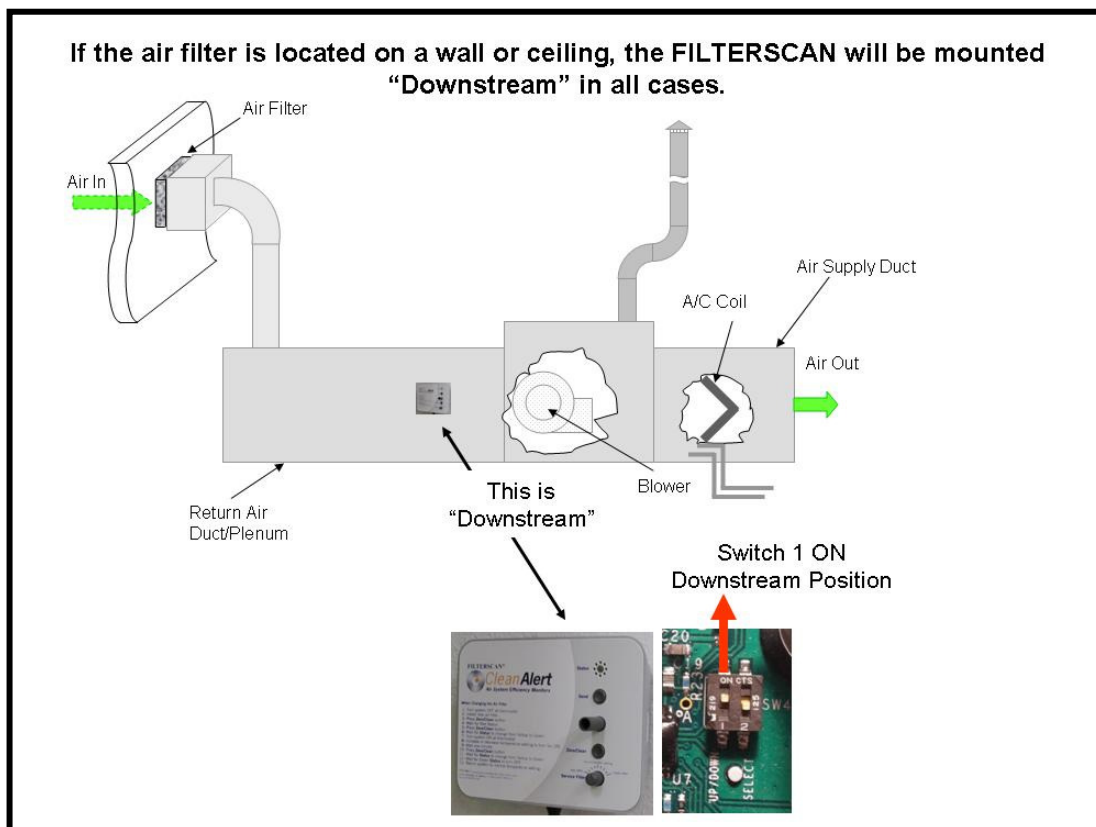
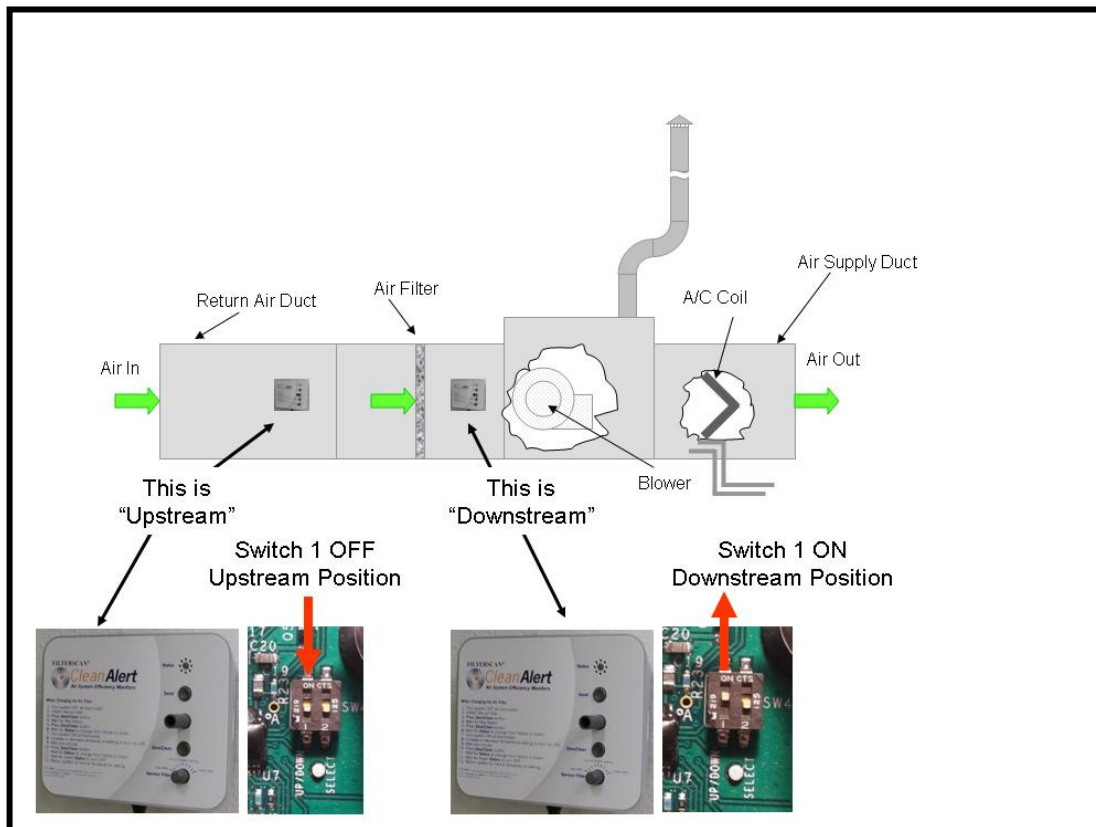

## Optional Dry Contact Relay Output

### FILTERSCAN Model FS-242-C and FS-242-CW Wiring (with optional relay output)

Optional Alert Dry Contact Relay Output  
Activates momentarily upon any alert

Maximum  
Switching  
Current:  
1.0A

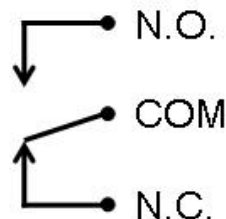

#### **Disclaimer**

The data contained herein are furnished for information only and are believed to be reliable. We cannot assume responsibility for the results obtained by others over whose methods we have no control. It is the user's responsibility to determine suitability for the user's purpose and to adopt such precautions as may be advisable for the protection of property and of persons. In light of the foregoing, the warranty of CleanAlert, LLC on this product shall be exclusive and in lieu of any other warranties, including, without limitation, any warranty of fitness for a particular purpose or warranty of merchantability or any other warranties which may be claimed to arise by operation of law, custom, trade usage, or course of dealing between CleanAlert, LLC and the customer. In no event shall CleanAlert, LLC be liable, whether in contract or tort (including negligence) for damages in excess of the amount of money that CleanAlert, LLC charged for the product(s), or for any indirect, incidental, special or consequential damages of any kind, or loss of revenue or profits, or other financial loss arising out of or in connection with the ability or inability to use the product(s), to the full extent these damages may be disclaimed by law. The discussion herein of various applications is not to be interpreted as representation that they are free from domination of patents owned by others or as a license under any CleanAlert, LLC patents that may cover such applications. We recommend that each prospective user test his proposed application before use, using this data as a guide.

CleanAlert products are manufactured under one or more of the following U.S. Patents: 7,178,410; 7,490,512; and others pending. Specifications are subject to change without notice.  
© 2012, 2013 CleanAlert, LLC