



Submittal Data Information

101-033

Model 0010 Cartridge Circulator

Effective: September 1, 2003

Supersedes: July 1, 2001

Job: _____ Engineer: _____ Contractor: _____ Rep: _____

ITEM NO.	MODEL NO.	IMP. DIA.	G.P.M.	HEAD/FT.	H.P.	ELEC. CHAR.

Features

- Standard High Capacity Output-Compact Design
- Quiet, Efficient Operation
- Direct Drive-Low Power Consumption
- Unique Replaceable Cartridge Design-Field Serviceable
- Self Lubricating
- No Mechanical Seal
- Unmatched Reliability-Maintenance Free
- Universal Flange to Flange Dimensions
- Cast Iron or Bronze Construction

Materials of Construction

Casing (Volute):	Cast Iron or Bronze
Stator Housing:	Aluminum
Cartridge:	Stainless Steel
Impeller:	Non-Metallic
Shaft:	Ceramic
Bearings:	Carbon
O-Ring & Gaskets:	EPDM

Model Nomenclature

- F – Cast Iron, Flanged
- BF – Bronze, Flanged
- Variations:**
- Z – Zoning Circulator
- J – Bronze Cartridge with Cast Iron Casing

Performance Data

- Flow Range: 0 – 30 GPM
 - Head Range: 0 – 11.5 Feet
 - Minimum Fluid Temperature: 40°F (4°C)
 - Maximum Fluid Temperature: 230°F (110°C)
 - Maximum Working Pressure: 125 psi
 - Connection Sizes: 3/4", 1", 1-1/4", 1-1/2" Flanged
- 
- FOR INDOOR USE ONLY**

Application

The Taco 0010 is designed for a wide range of Large Residential/Light Commercial water circulating applications. Typical uses include Hydronic heating, Radiant heating, Primary-Secondary loops, Indirect water heaters, Chilled Water cooling, and Potable Hot Water systems. The Bronze 0010 is designed for all open-loop, fresh water systems. The unique replaceable cartridge contains all of the moving parts and allows for easy service, instead of replacing the entire circulator. Compact, direct-drive, low power consumption design makes it ideal for high-efficiency jobs.

Pump Dimensions & Weights

Model	Casing	A		B		C		D		F		G		Ship Wt.	
		in.	mm	in.	mm	in.	mm	in.	mm	in.	mm	in.	mm	lbs.	Kg
0010-F2	Cast Iron	7-1/4	184	5-5/16	135	3-3/16	81	3-5/16	84	5-3/8	137	6-3/8	162	13	6
0010-BF2	Bronze	7-1/4	184	5-5/16	135	3-3/16	81	3-5/16	84	5-3/8	137	6-3/8	162	13	6

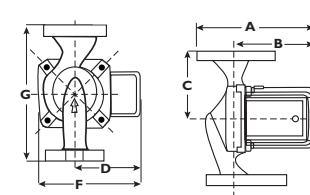

Mounting Positions

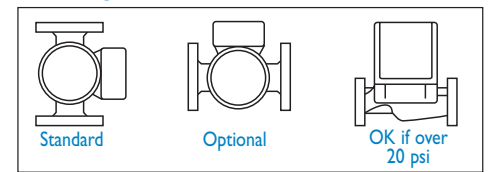

Electrical Data

Model	Volts	Hz	Ph	Amps	RPM	HP
0010-F2	115	60	1	1.10	3250	1/8
0010-BF2	115	60	1	1.17	3250	1/8
Motor Type	Permanent Split Capacitor Impedance Protected					
Motor Options	220/50/1, 220/60/1, 230/60/1, 100/110/50/60/1					

Flange Orientation

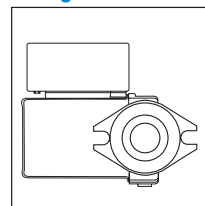

Performance Field - 60Hz

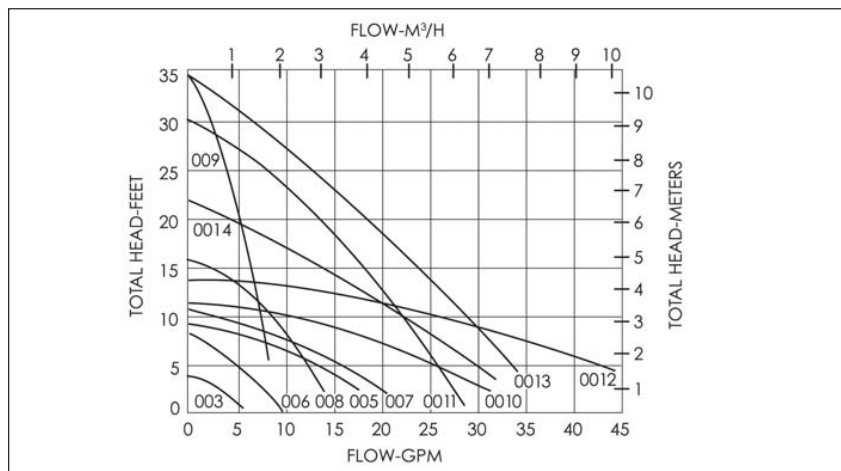

Do it Once. Do it Right.

Taco, Inc., 1160 Cranston Street, Cranston, RI 02920 Telephone: (401) 942-8000 Fax: (401) 942-2360
 Taco (Canada), Ltd., 6180 Ordan Drive, Mississauga, Ontario L5T 2B3 Telephone: (905) 564-9422 Fax: (905) 564-9436

Printed in USA
 Copyright 2005
 TACO, Inc.

Visit our website at: www.taco-hvac.com