

# Little GIANT<sup>®</sup> Pump Company

Condensates

---

## VCMA-15 SERIES

---

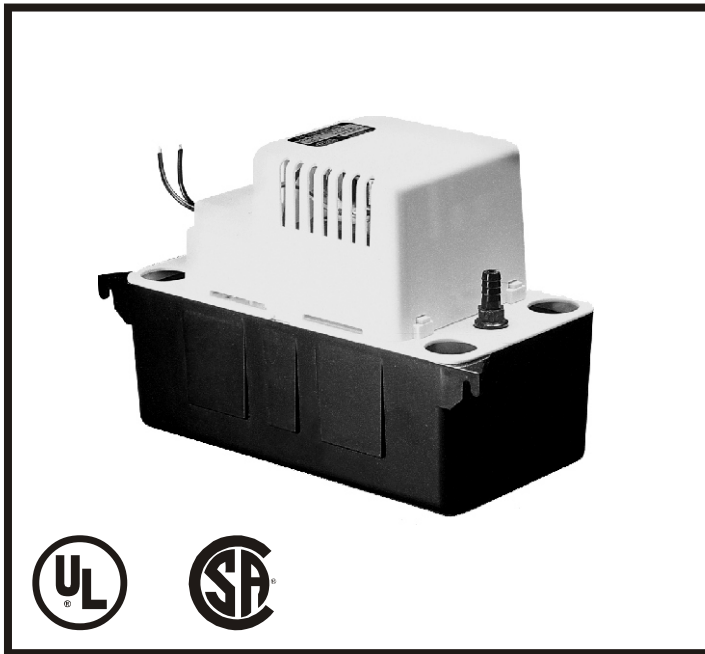

### Features

- Vertical type pump unit
- 1/2 gallon leakproof, rustproof, ABS tank with mounting tabs
- Stainless steel motor shaft
- 3 drain holes
- 3/8" O.D. barbed discharge adapter
- Built-in check valve
- Optional Safety Switch
- 15' shut-off head
- 6' power cord
- UL/CSA listed
- Thermal overload protected
- Suitable for High-Efficiency, gas furnace condensate

### Construction

- Motor — 1/60 HP
- Intermittent Liquid Temp. up to — 120° F
- Discharge — 3/8" OD barbed
- Housing — ABS
- Cover — ABS
- Volute — ABS
- Impeller — Glass filled polypropylene

The VCMA Series is a fully automatic condensate removal pump with 1/2 gallon capacity. The series features a vertical-type pump with stainless steel motor shaft, rust proof, high-impact ABS volute, tank and motor cover, 3 drain holes, removable 3/8" O.D. barbed check valve. (ULS) models include a safety switch that can be connected to shut down the air conditioner condenser or wired to an alarm to warn of possible tank overflow. (T) models include 20' of 3/8" ID tubing. Pump is rated for high-efficiency gas furnace applications that produce an acidic condensate. Thermally protected motor is UL and CSA listed.

# Little Giant Pump Co.

## VCMA-15 SERIES

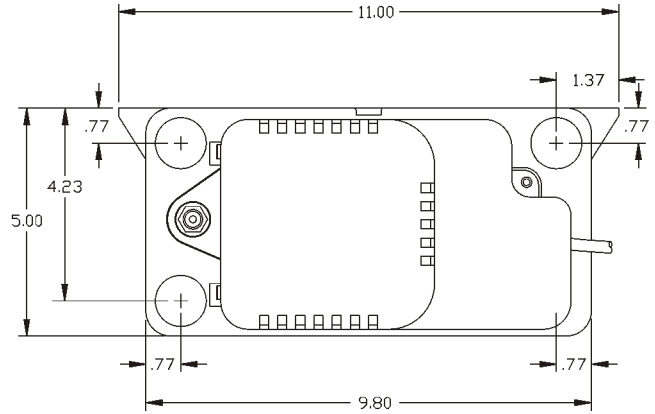
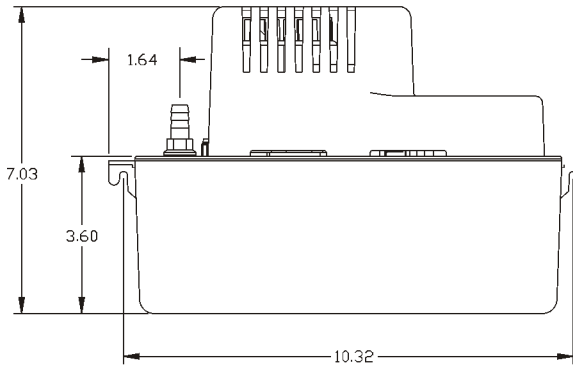

### Specifications

Model No.	Item No.	Discharge Size	Listing(s)	HP	Volts	Hertz	Amps	Watts	Performance (GPH @ Head)				Shut Off		Pwr. Cord (ft)	Weight (Lbs.)
									1'	5'	10'	20'	Feet	PSI		
VCMA-15UL	554401	3/8" OD Barbed	UL/CSA	1/60	115	60	1	60	65	50	25	0	15	6.5	6	4.40
VCMA-15ULT	554411	3/8" OD Barbed	UL/CSA	1/60	115	60	1	60	65	50	25	0	15	6.5	6	5.80
VCMA-15ULS	554405	3/8" OD Barbed	UL/CSA	1/60	115	60	1	60	65	50	25	0	15	6.5	6	4.40
VCMA-15ULST	554415	3/8" OD Barbed	UL/CSA	1/60	115	60	1	60	65	50	25	0	15	6.5	6	5.80

NOTE: GPH is through check valve.

### Replacement Parts

Tank	154401
Cover, Tank	154411
Motor/Pump Assy	154491
Cover, Motor	154421
Float Arm	154452
Switch Holder	154471
Switch	950337
Check Valve	154715

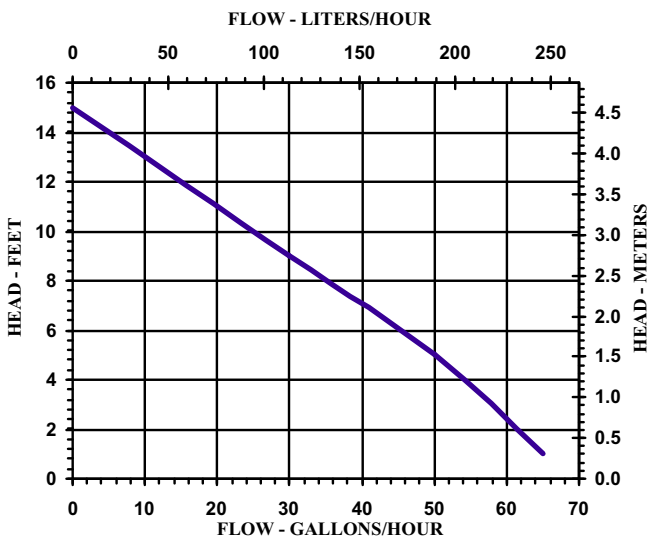

### Little Giant Pump Co.

PO Box 12010 • Oklahoma City, OK 73157

Phone: 405.947.2511 • Fax: 405.228.1550

E-mail: [customerservice@littlegiant.com](mailto:customerservice@littlegiant.com)

Form No. 995124 - 03/03